

Patron & Release metal tubes

Product code
351 165

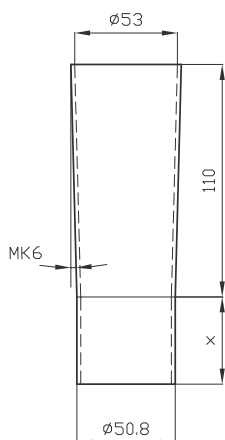

Product code
351 165-C

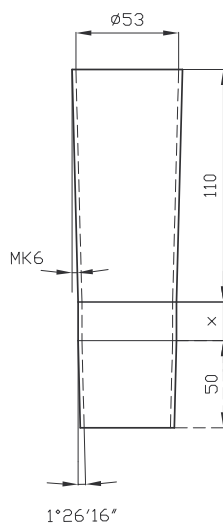

Product code
351 165-M12

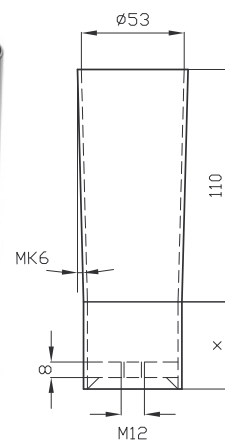

Inspiration & Assembling

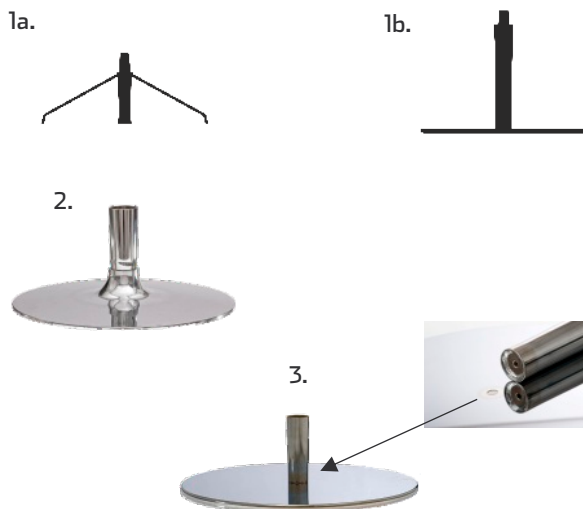

Assembling instructions

- The Patron swivel is to be pressed into the tube
- 1. To be welded to metal legs (1a) / base (1b)
- 2. To be assembled to a center hole of base Ø50mm
Conicity 1°26'16"
- 3. To be fastened to a base by an M12 screw
- Ask for our assembly instructions

Product information

Tapered metal tube models for Patron and Release swivels, made from 50,8 x 2,00 or 50,0 x 2,00mm tubes.

Form	Product code	Minimum length
1 * cone	351165	125mm
2 * cone	351165-C	165mm
1 * cone M12	351165-M12	135mm

If welded tube can deform and needs to be reshaped.

Specifications

- MK6 = 1°29'36"
- Standard made from metal pipe Ø50.8mm.
- Wall thickness of standard pipe 2mm.
- Raw metal surface, II-class for painting

Options

- Surface: painted or chrome (matt/shiny). Other surfaces on request
- Length
- Upper conicity of tube could be made deeper to assemble the swivel at a lower level (counter sunk)
- Also available in Aluminium or stainless steel K320